

Wheel diameter	叶轮直径	D = 560 mm	Fan weight	风机质量	m = 171 kg
Moment of inertia	转动惯量	J = 1.42 kg·m ²	Speed limit	极限转速	n _{max} =2600 r/min

性能曲线

经认证的性能是B类安装：自由入口，管道出口。功率额定值(kW)不包括传输损失。各项性能额定值不包括附属物(附件)的影响。所示A加权声音性能额定值已按AMCA International标准301计算。所示值为安装类型B：自由入口，管道出口的声功率级（入口L_{WA}）。

Performance Curve

Performance certified is for installation type B: free inlet, ducted outlet. Power rating (kW) does not include transmission losses. Performance ratings do not include the effects of appurtenances (accessories). The A-weighted sound ratings shown have been calculated per AMCA International Standard 301. Values shown are for inlet L_{WA} sound power levels for installation type B: free inlet, ducted outlet.

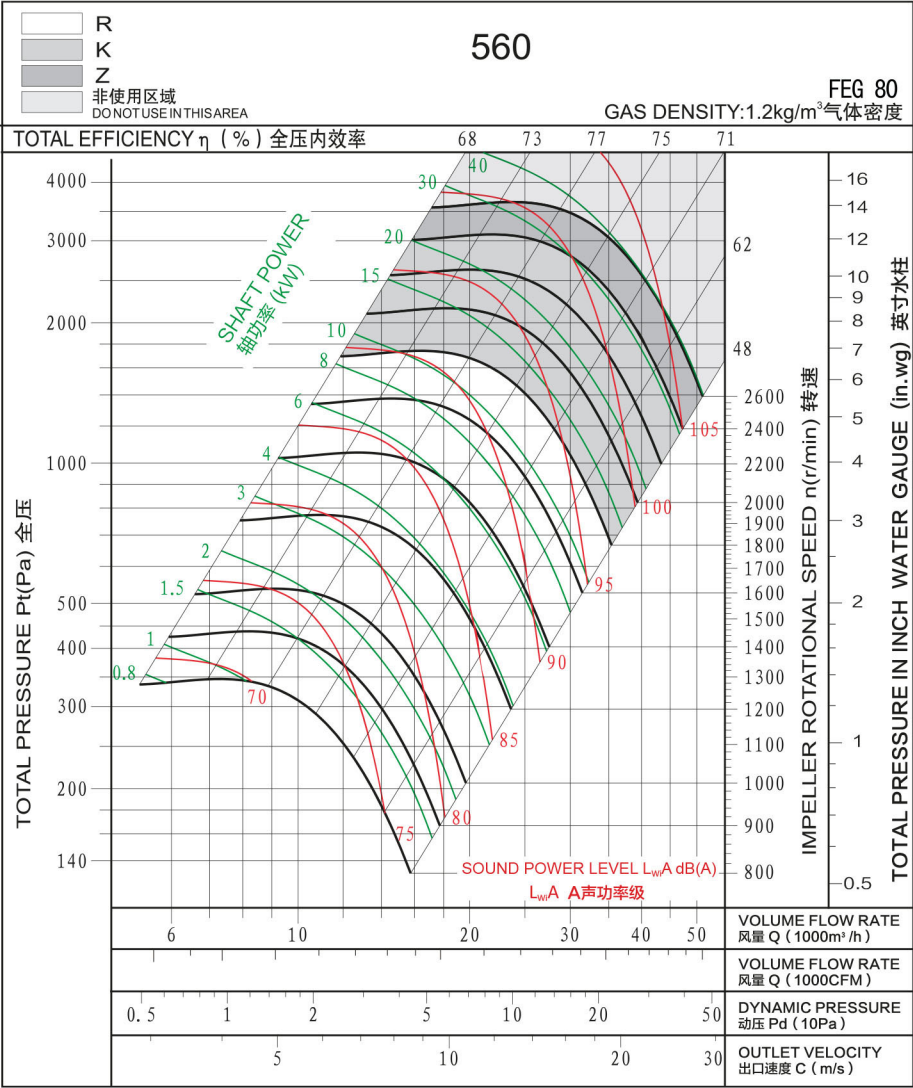

Measured in installation B according to AMCA Standard 210

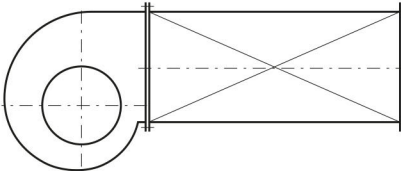

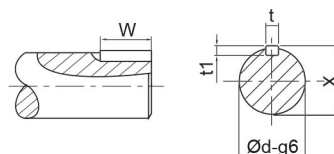
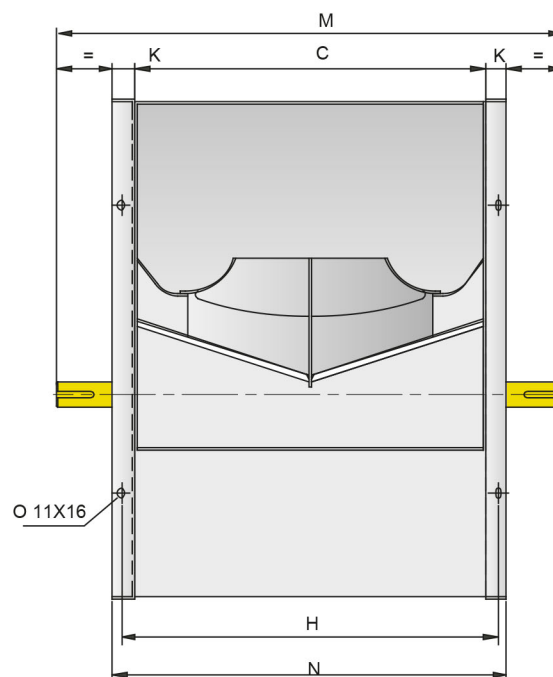
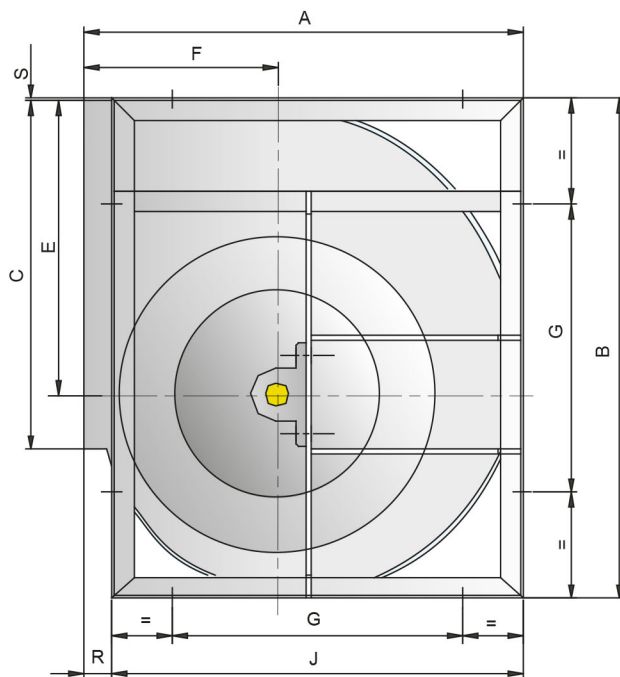

单位: mm

Model Dim	A	B	C	E	F	G	H	J	K	M	N	R	S	t	t1	W	X	Ød	LxV
280	466	518	361	302	215	280	391	432	30	575	421	34	5	8	7	50	28	25	13x18
315	518	578	404	340	236	280	434	480	30	640	464	38	3	8	7	60	28	25	13x18
355	578	655	453	383	261	355	493	548	40	700	533	30	6	8	7	60	33	30	13x18
400	651	736	507	432	290	355	547	613	40	760	587	38	5	8	7	60	33	30	13x18
450	726	827	569	486	322	530	609	681	40	845	649	45	5	10	8	70	38	35	13x18
500	800	918	638	538	352	530	678	750	40	915	718	50	5	10	8	70	38	35	13x18
560	893	1030	715	603	390	530	765	845	50	1000	815	48	8	12	8	70	43	40	13x18
630	999	1157	801	679	434	530	851	946	50	1090	901	53	7	14	9	70	49	45	13x18
710	1121	1303	898	765	485	630	948	1058	50	1255	998	63	7	14	9	90	54	50	17x22